















[Pantheon Bazaar, 1845.]

















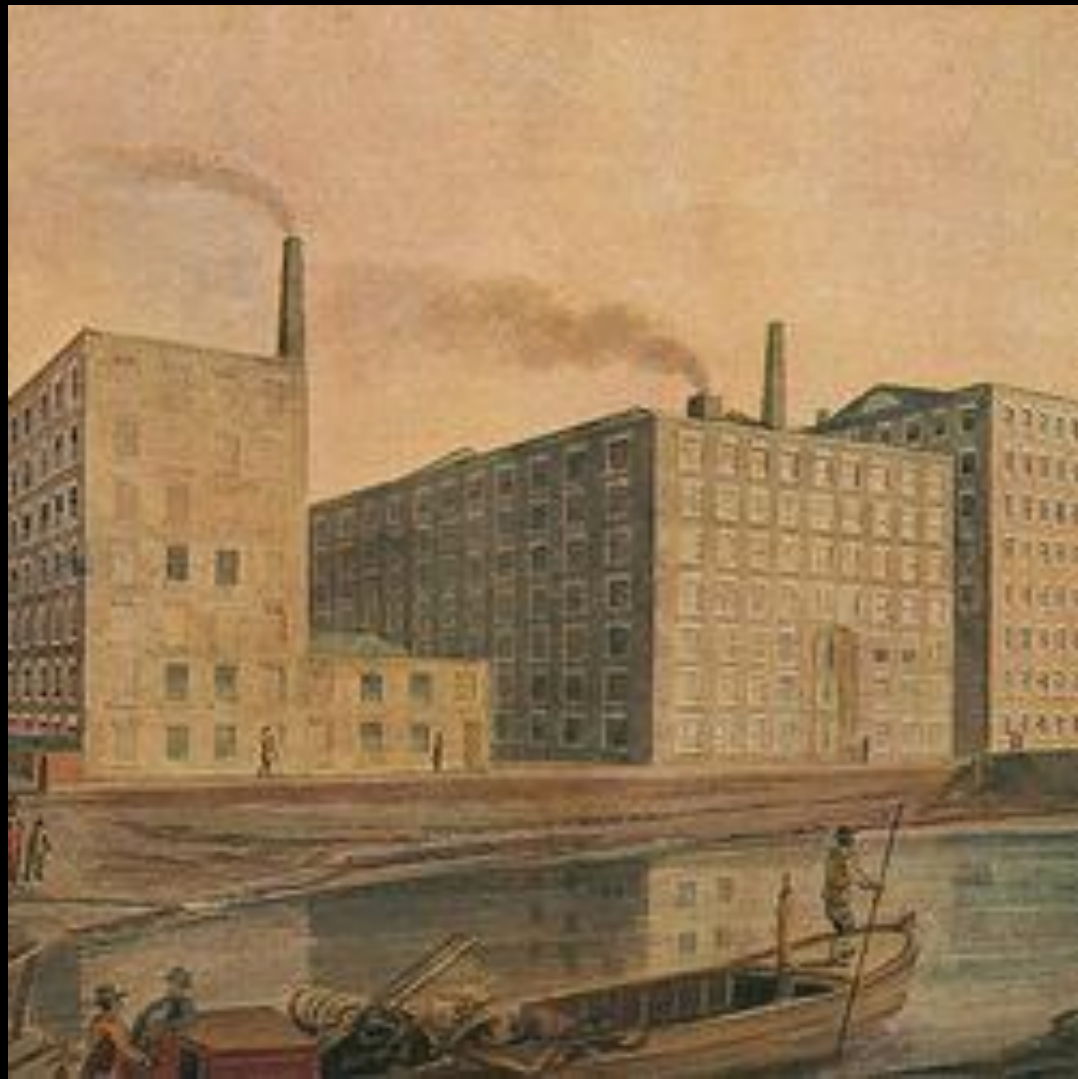











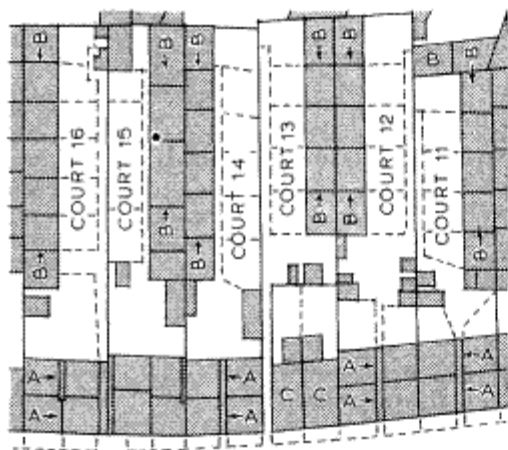

GREAT COLMORE STREET

Broken lines indicate individual gardens

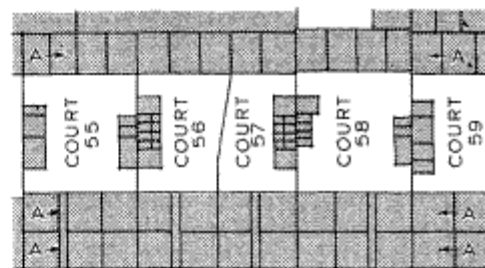

NEW JOHN STREET WEST

A↔A Three-storied back-to-back houses

B↔B Two-storied back-to-back houses

C "Through" houses

0 50 100 Feet

# BACK-TO-BACK HOUSES

## A TYPICAL COURT OF 14 BACK-TO-BACK HOUSES

The three general plans are shown in the block adjoining the street; the block at the back of the court; and in the inset.

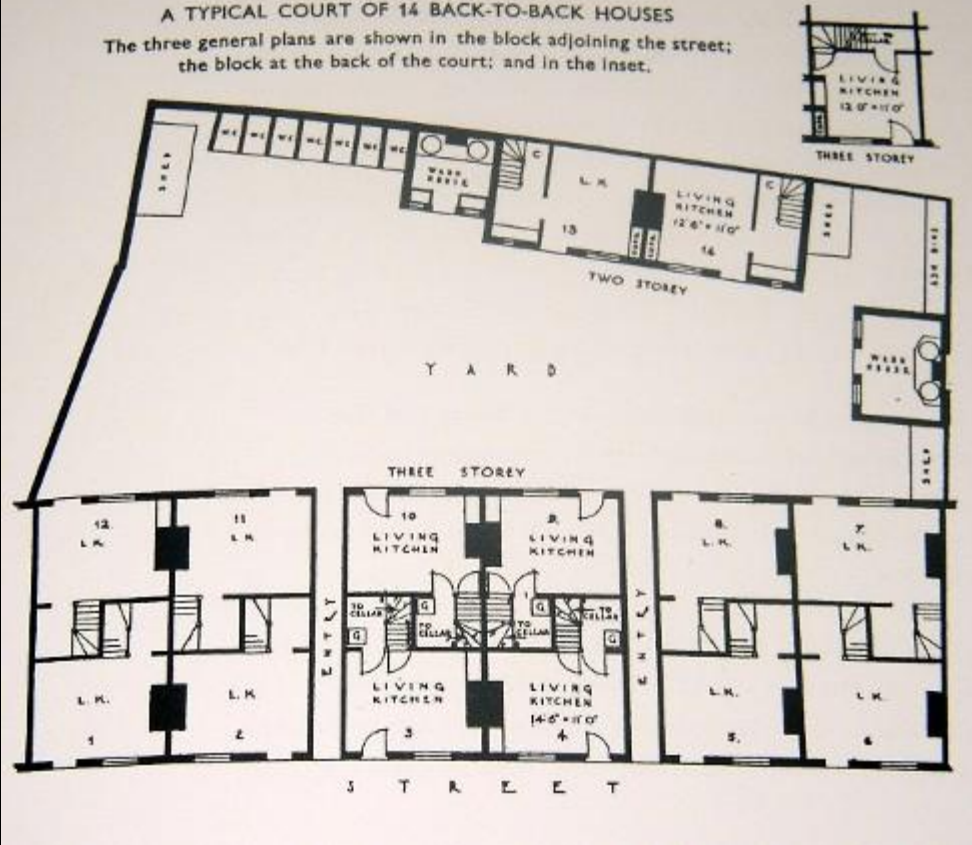

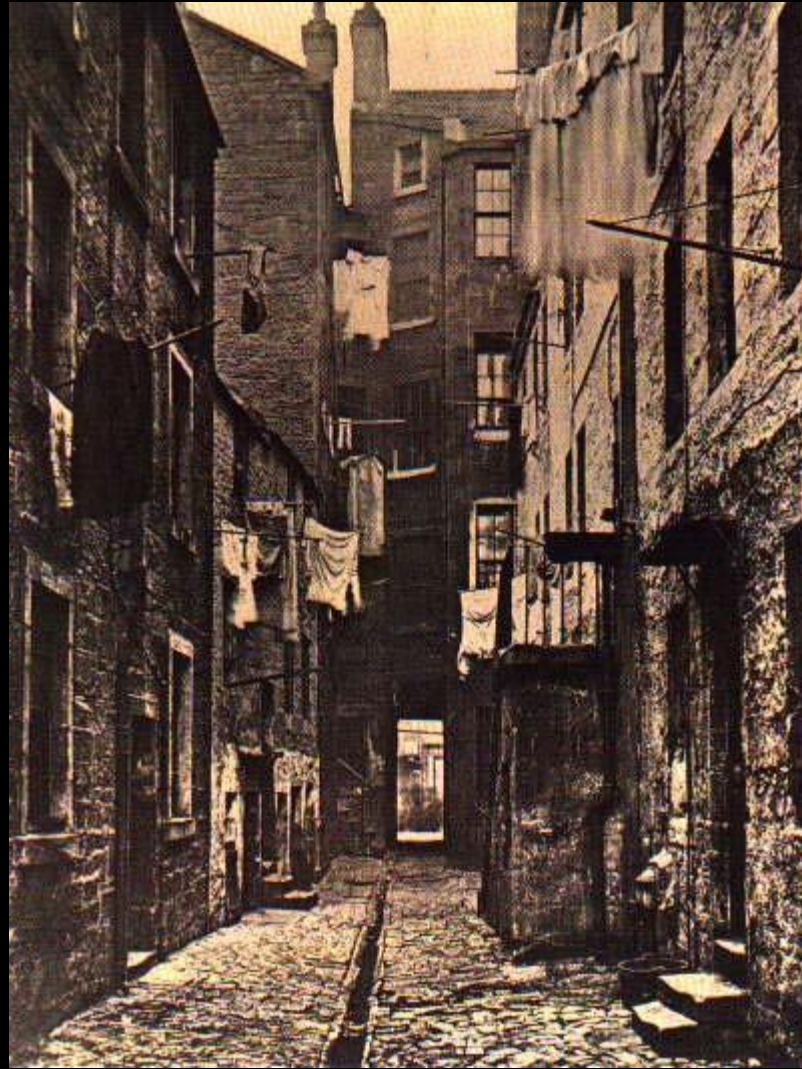





























*J. Chambers del. View of the Bank of England*





A View of the BANK of ENGLAND, *Threadneedle Street, London.*

*Engraved from a drawing by J. G. Kneller, Esq. and published by J. G. Kneller, Esq. at the Bank of England, in the Strand, London.*

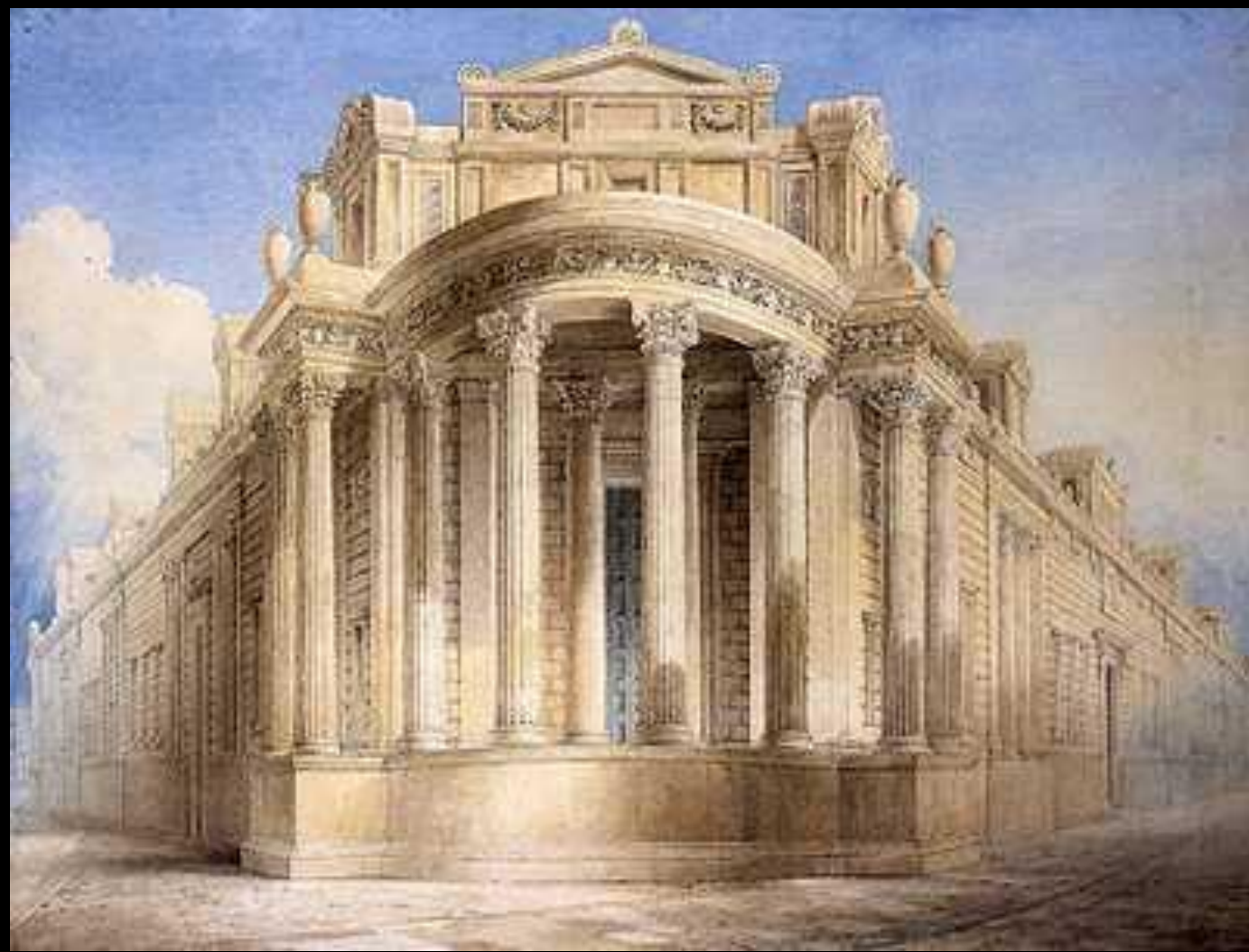











postcardsthenandnow.blogspot.com

*Queen Victoria Street, London, E.C.*



postcardsthenandnow.blogspot.com



















A CITY BANKING PALACE: THE NATIONAL PROVINCIAL BANK, BISHOPSGATE-STREET.—SEE NEXT PAGE.

